

Elokon anuwana **m**ule,
akale **m**ule

Mae **m**ae atantimoko

Elo **m**atapi po, **m**atapi
po

Mokusali, **m**okusali
atali**m**oko.

Tukutimi 14

Elokon - elo

M m m M



Akale mule

Akale mule

Tikami 1: Elokon ukusan umenko [m] etali yako o'wa.

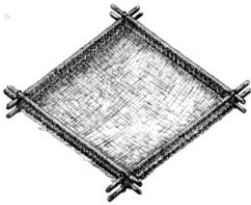

Tikami 2 : Elokon ukusan upino itakako oye [m] etali
yako o'wa.



--	--

--	--	--

--	--	--	--

--	--	--	--

Tikami 3 : l , L , l , L eneli yako o'wa ikulipako.

L	M	B	l	T	L	V
t	Z	L	f	l	i	l

Tukutimi 14

Tikami 4 : Molokon atiwano ikako la'a iyonpo imeloko upinoine.

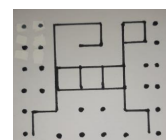
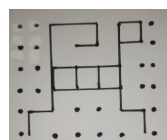
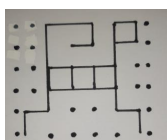
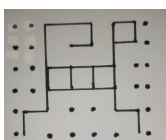
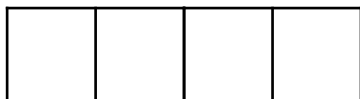
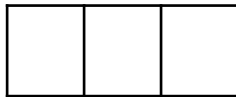
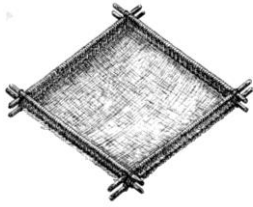

Tikami 5 : Sipulu ikako lapa.

Sipulu meli

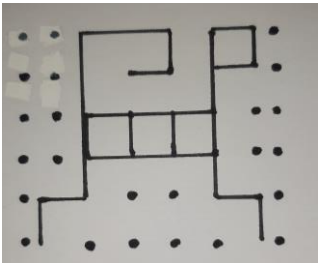

Tukutimi 14

Tikami 6 : Molokon isikiipo ikako la'a.

Pilipili esiwo mosokoloi pe man.

Yaluwai matapi kasan.

Kolopo maina wa kinitan.

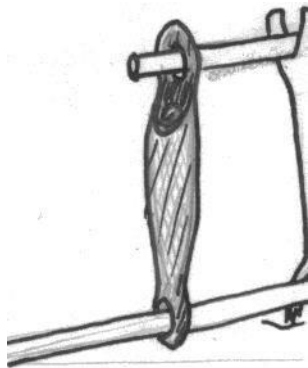

Ayepaton

Pilipili -
mosokoloi -
matapi -
maina

Tikami 7: Ekalito oti wepasamali.

Nokan ko pilipili esiwo nan?

Oti ksan ko Yaluwai ?

Oya ko nitan kolopo?

